

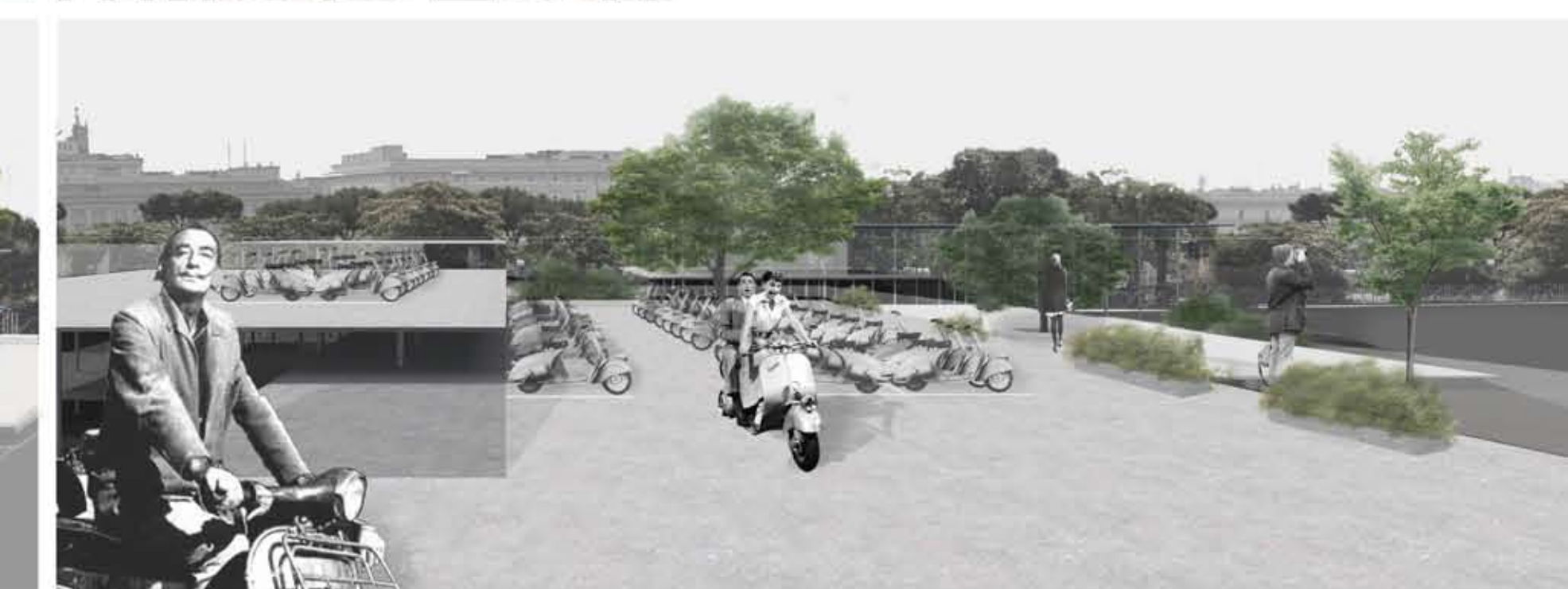

# RMCP ZJK

Considering motorinos as a dynamic, versatile vehicle, the parking could not be a static system but a new frame for experience and interacting with the urban scene. The great urban void in Piazza dei Cinquecento becomes a hall to the train station, saturated with parking areas and little comfortable public spaces. This meant an opportunity to create and multiply public space generating small squares in different heights. The aim of the project is not to build a compact block, but to dematerialize the parking in a system of horizontal planes dialoging with all cantilevers, pergolas, covers and other elements we find in the site. From inside the parking, views are extended throughout the city, blurring the limits of the project and the piazza.

The different parts of the program are fit into the horizontal planes system in different levels. A network of slight ramps connect the different "trays" and the street, organizing movement in the system. Existing vegetation is introduced in the proposal by integrating the biggest trees through holes in the planes. The small ones are planted out into new green areas in the project.



**RAMPS**  
Movement in  
the system

**HORIZONTAL PLANES**  
"Trays" diffuse limits,  
relation with the city

**STRUCTURAL GRID**  
Forest of columns

**VEGETATION**  
Trees through the planes  
and pots in different levels

**STEREOTHOMIC  
PLYNTH**  
Space conveyed  
as subtraction

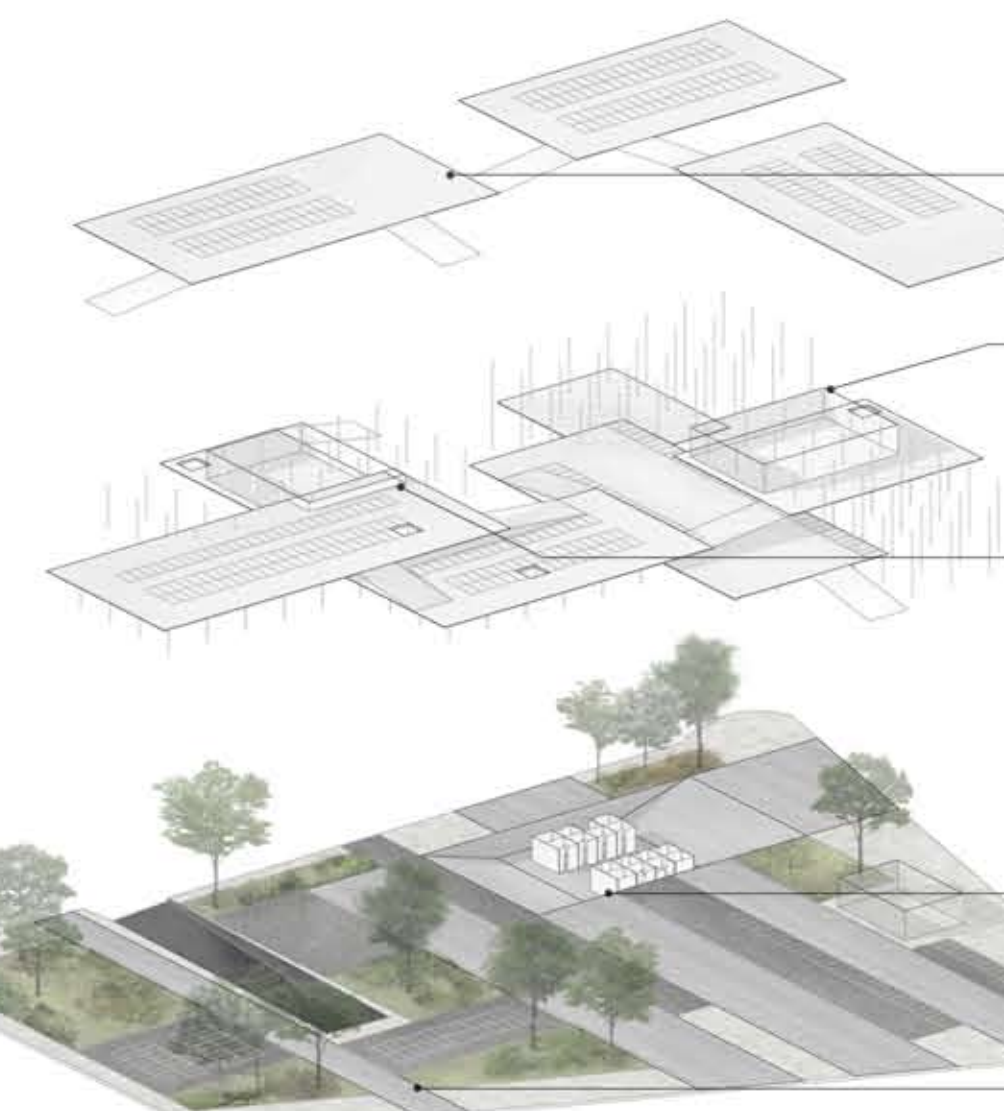

**MULTIPLYING PUBLIC SPACES**  
In the different concrete planes, free open  
areas are alternated with the parking spaces

**CAFE BAR AND PUBLIC TOILETS**  
Terrace and bar separated from the parking areas

**WORKSHOP CLASSROOMS**  
Movable pannels enable different configurations  
of space depending on demands

**MOTORBIKE PARKING**  
Placed on the ground floor with direct access,  
and in the different levels on the planes

**WASHING SERVICE & REPAIR SHOP**  
Individual cells containing the different functions

**BIKE PARKING**  
Placed on the ground floor,  
direct-quick access from the pathways

